

# To the beach

**This task is about listening to a set of directions and following instructions to show this information on a map.**

Listen to the directions about how to get to the beach and follow the instructions in the questions that follow.

- Put a circle around the big pohutukawa tree that Pio and Langi are to turn at.
- Write in the name High Street in the right place.
- Put an x on the pedestrian crossing that Pio and Langi will use.
- Draw and label the beach where they will swim.
- Draw a line from Aunt Jessie's house to the beach to show the route they should take.

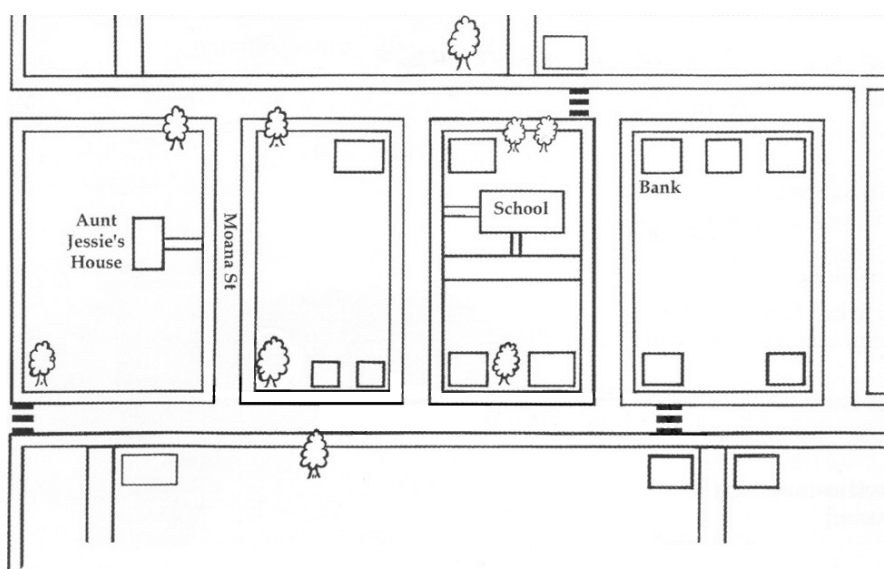

Published on <https://newzealandcurriculum.tahurangi.education.govt.nz>